



CONTINENTAL®
frameless glass | steam | sauna | spa

APP MANUAL FOR iTOUCH STEAM GENERATOR

With the addition of the WF50 WIFI box, the GS08M steam generator can be controlled remotely via our APP on your mobile. Please note that you will need an existing wireless router.

1.Download APP on mobile

A. For Android phone,
Scan QR to install APP.

B. For IOS Phone (Iphone)
Search “**Smart Life**” in APP STORE directly to download APP



Android QR Code

C. Enter download interface as show on pictures, click“**download**”and install the APP.

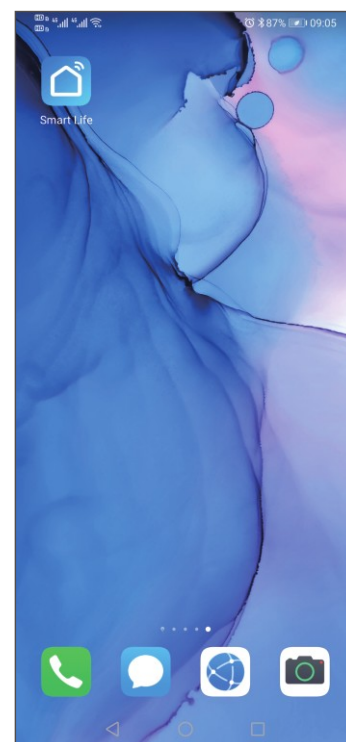
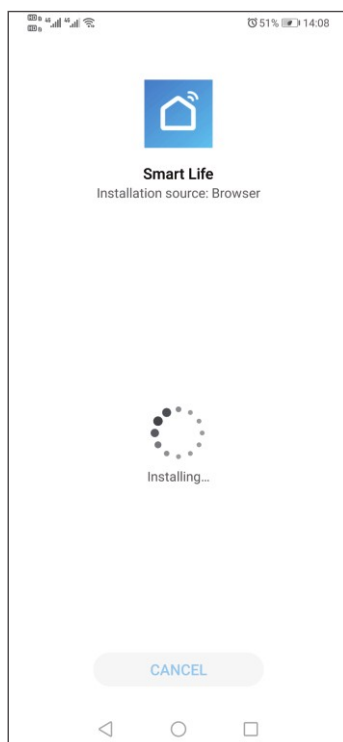
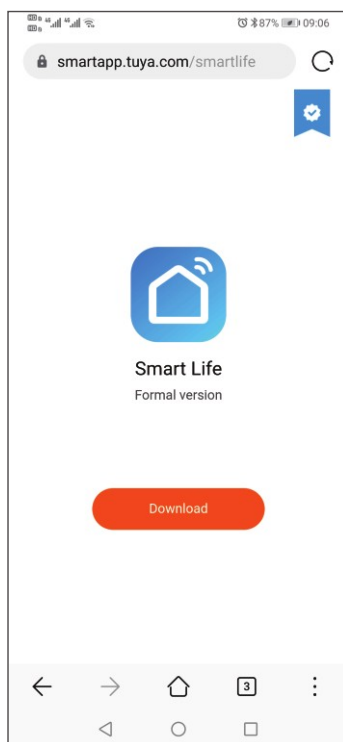

2.User registration and sign in

Click APP logo“**Smart Life**” to enter into login interface as picture shown, if it’s your first time logging in, You will need to register a new user account. Please follow the guide by clicking the Register Button.

Register a new user account
Click Log In, if you already have user account

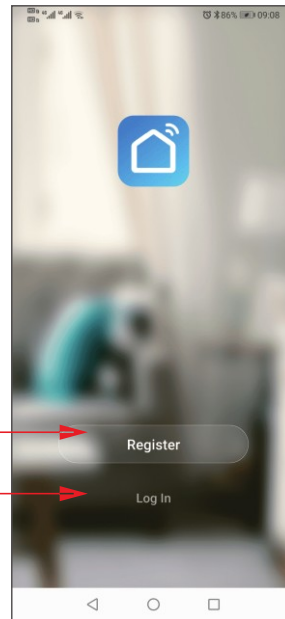

3. Adding your steam generator to the App List

On first time use, you have to add your steam generator to the device list.

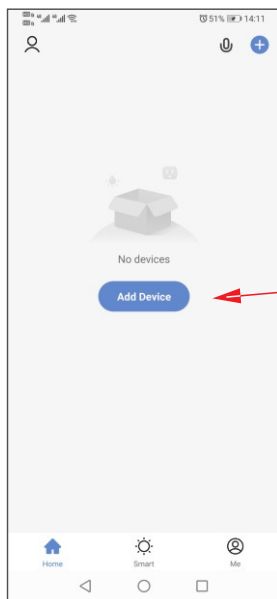

Click "Add Device"

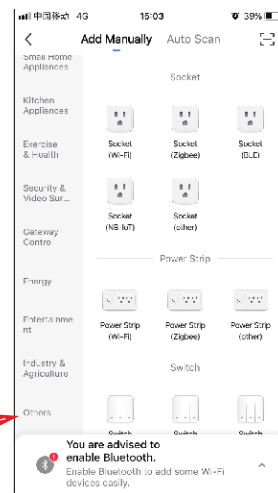

Click "others"

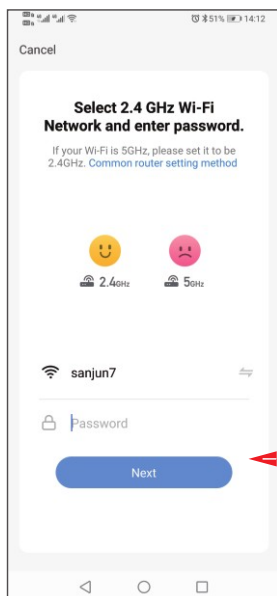

Input your WIFI password and Click "Next"

In others to choose "other (Wi-Fi)"

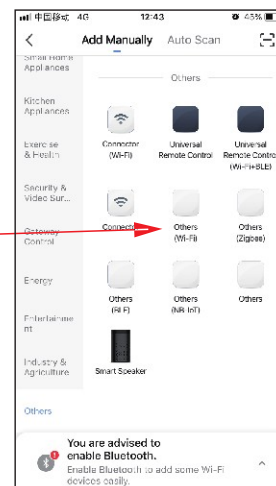

Before you click next, you need to put the steam generator into WIFI matching mode.

1. Power on the iTouch Keypad.
2. Touch the  button to enter the setting interface as displayed in picture below.
3. Move the arrow to **“factory settings”**.
4. Press and hold the **“OK”** button for 2seconds, you will hear a **“BEE”** sound, the system is now in the WIFI matching state.

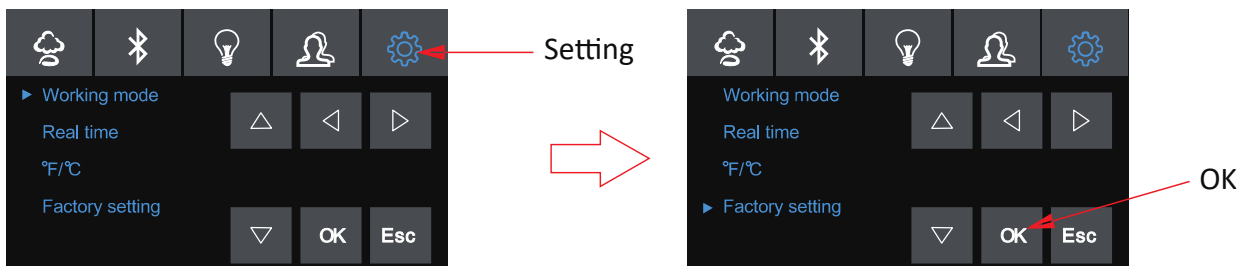

Now that your steam generator is in matching state click **“Next”** on the APP to add steam generator to the APP and enter into product operation interface.

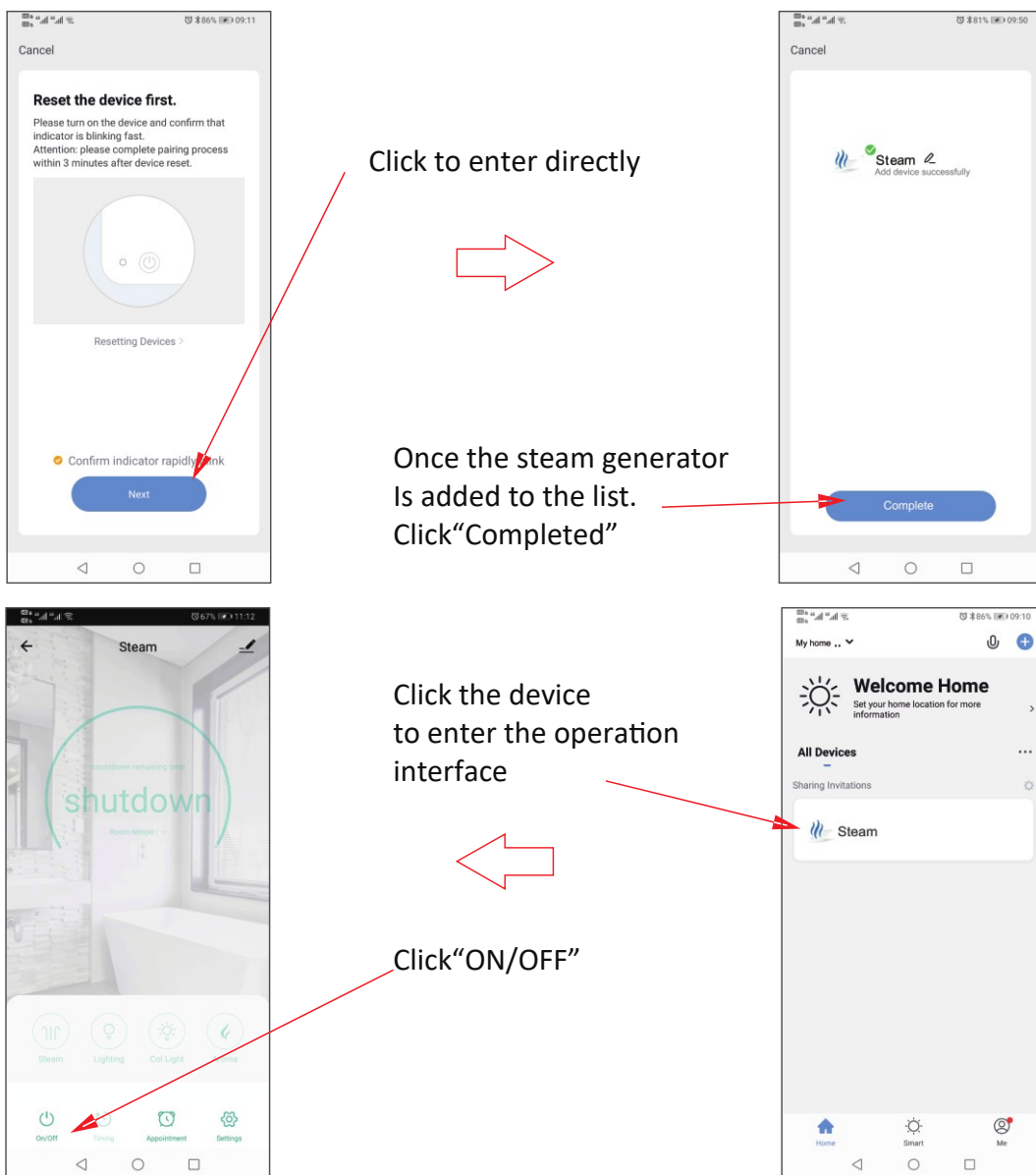

4.Operation interface of steam generator

Exit the APP interface

Change the name, Example:
Main Bedroom Steam

Steam working time

Steam TEMP.

Chroma light
Light

Steam ON/OFF

Appointment

Timing

Power on/off

Setting

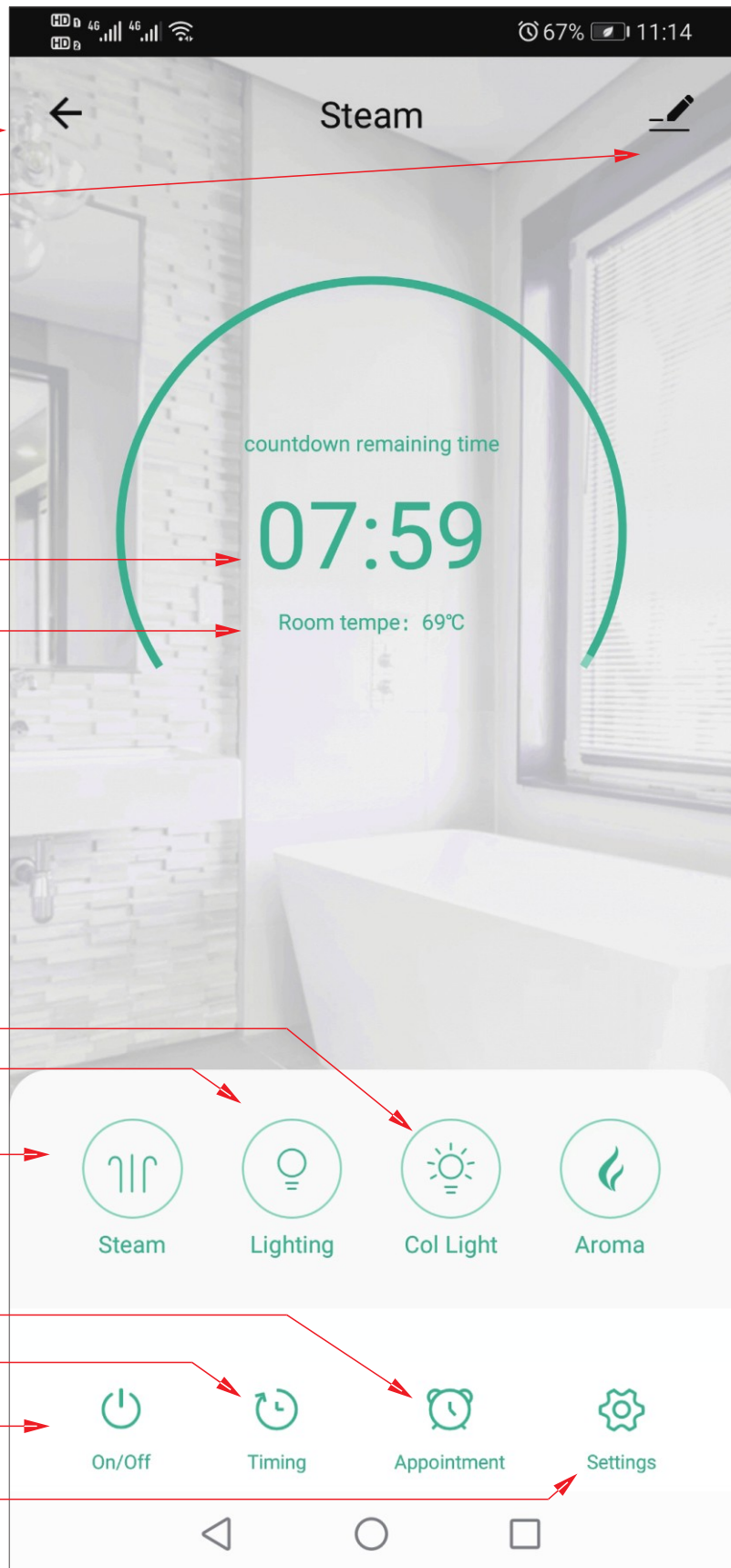

5.Function

A. Steam temperature Setting

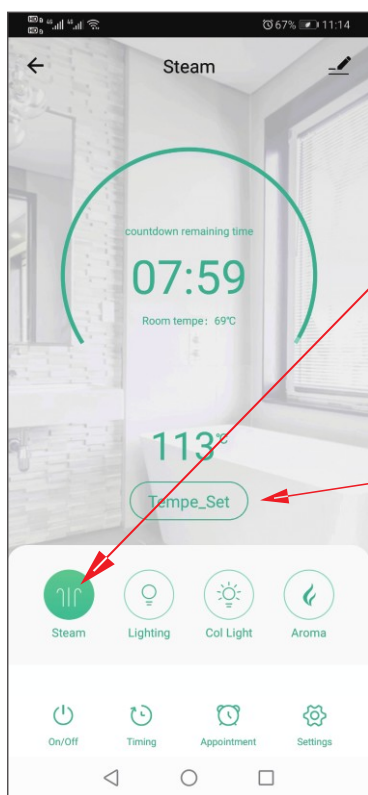

1. Click steam button

2. Steam function on , Click“Tempe_Set”

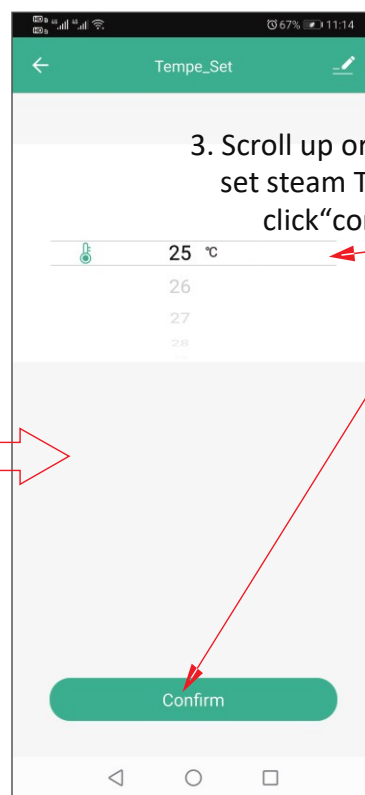

3. Scroll up or down to set steam TEMP and click“confirm”

B. Working Time Setting

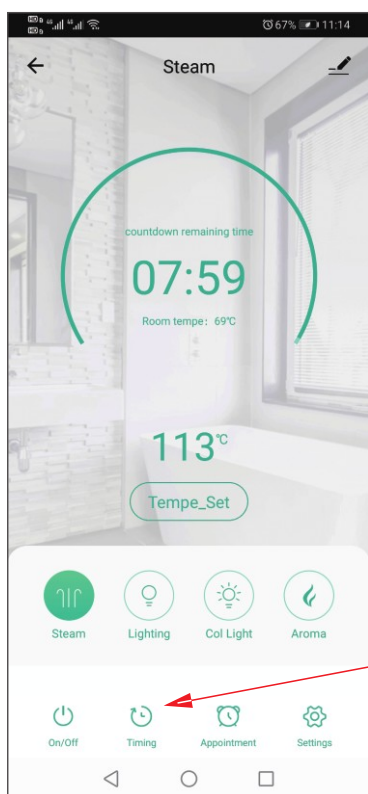

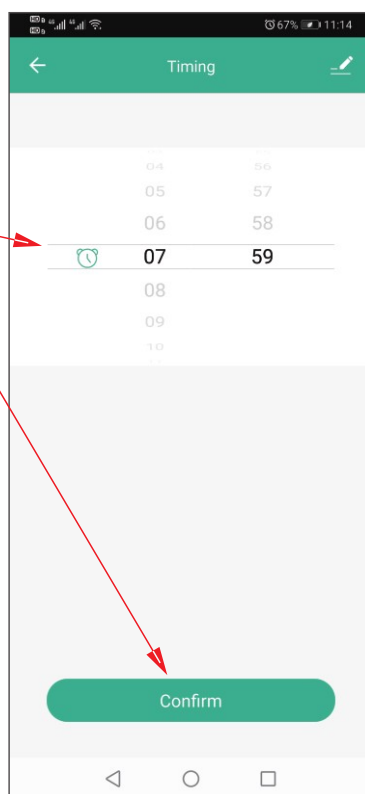

2. Scroll up or down to set steam Time and click“confirm”

Click“Timing”to enter timing setting interface

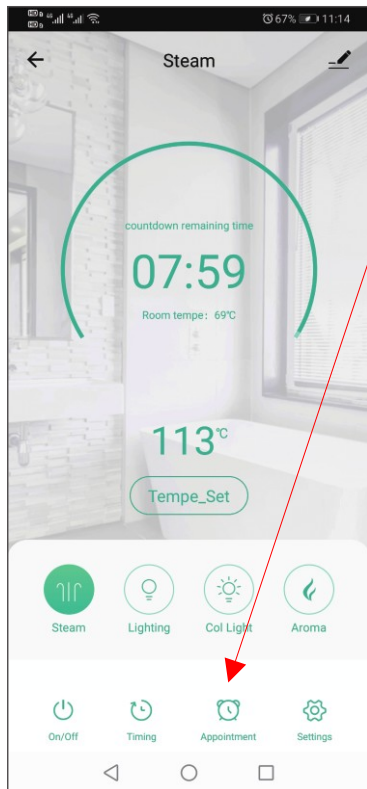

C. Appointment Setting



1. Click on the  icon

2. Scroll up or down to set steam working time.

3. Click Monday to Sunday to set working mode

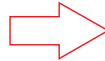

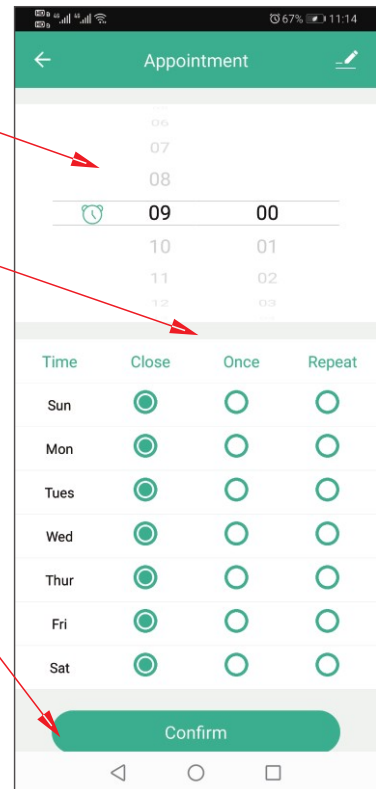

4. Click "Confirm"

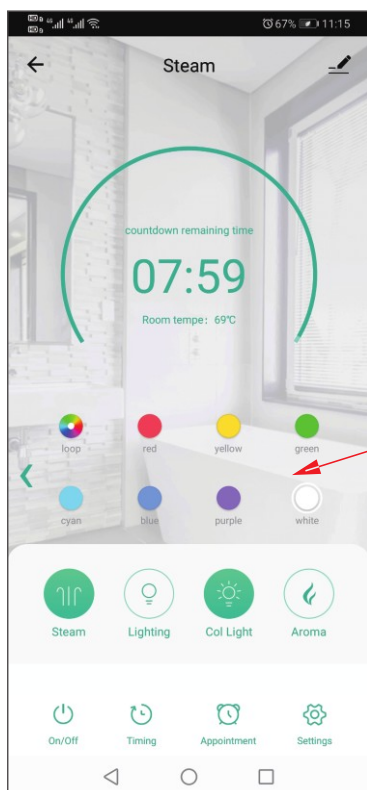

D. Chroma Light



Press  button to enter chroma light interface
Press the colour icon to set light colour you want.
When you select the Loop icon , The chroma light will automatically cycle through all colours.

E. Normal Light

Click on the  button to switch on/off the normal light.

F. Settings

1. Auto. clean function

When steam function is off, click “Automatic wash” to start cleaning function.

2. Temperature unit switch

Click temperature scale switch, the temperature unit can be switched between Celsius and Fahrenheit.

3. Real-time Clock

Click real time clock to synchronize the time displayed on your smart device to the iTouch control panel.

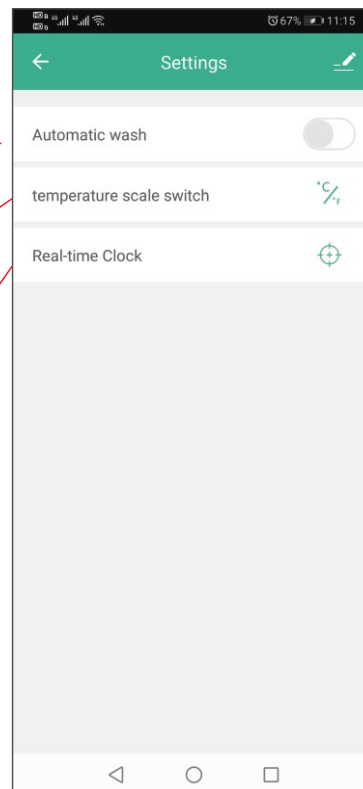

G. Parameter Settings

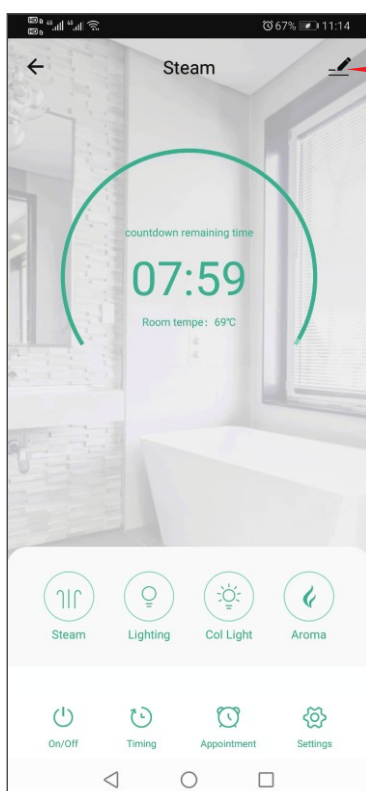

Click here to set more function

Device name Settings

Share devices with others

Click to remove device

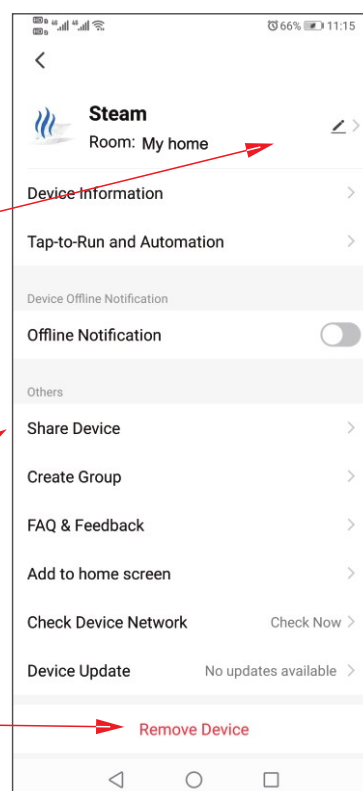

H. Share device and remove device

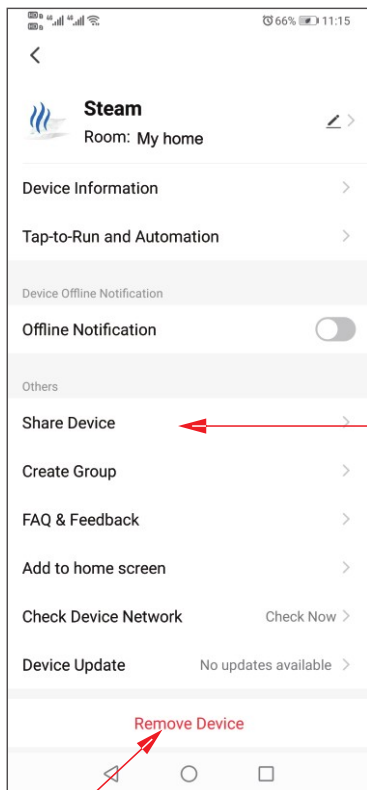

Click "Shared device"

Click "Add sharing"
To enter interface

Click to remove device

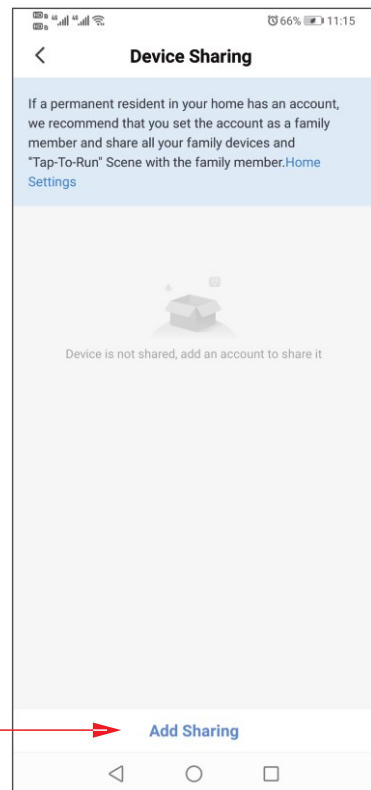

Enter the user account for whom you would like to share the device with. Please note that this user account must be registered on "smart life" APP.

After entering the user account, click "Done"

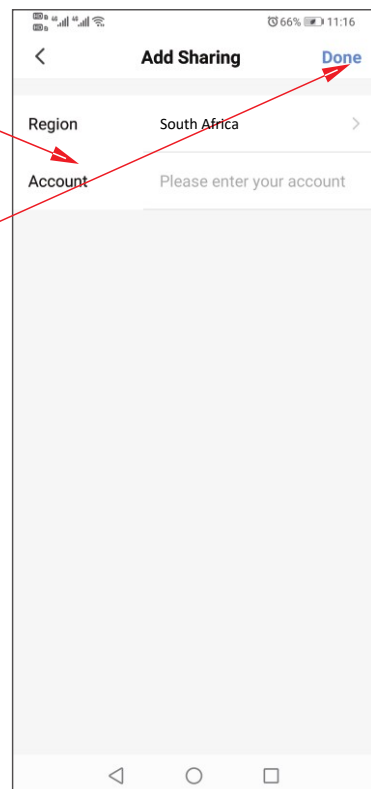

Continental Frameless Glass, Steam, Sauna & Spa (Pty) Ltd
411 Martin Crescent, Greenhills Industrial Estate,
Germiston, Gauteng, South Africa, 1416

Tel:+27 822 7170 | Web: www.continentalsa.co | Email: Sales@continentalsa.co